

FORMAX[®]

HERE BEGINS YOUR ULTIMATE VALUE

FVS-SM Series

Servo motor
Volumetric Screw Doser

FVS-SM



Please read the brochure carefully before operation.

■ Coding Principle

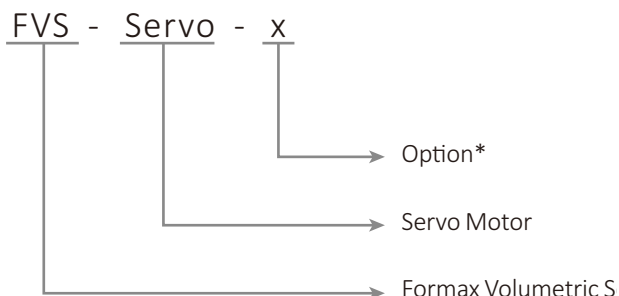

FVS-SM-MX-D

Note*:

MX(MX6)=6L Mixer

HF=Heavy Base LS=Level Sensor SF=Support Bracket VL=Ventruil Loader D=Double

■ Features

- Adopting servo motor control, accurate and smooth feeding, fast response speed.
- Equipped with 1:5 reducer, increase torque, not easy to overload.
- Single screw output up to 0.1~80KG/HR.
- Touch screen control, simple and clear operation.
- The screw is made of stainless steel, durable.
- Modular assembly structure, easy to disassemble, easy to clean and interchangeable.
- Extruder mode speed can be automatically adjusted with the extruder processing speed to maintain a fixed masterbatch ratio.
- Records existing operating patterns, unaffected by power outages, and resumes operation when power is restored.
- With forced cleaning function, easy to change the color masterbatch.
- With recipe storage function, can store 50 groups of recipes
- Equipped with RS485 communication function.

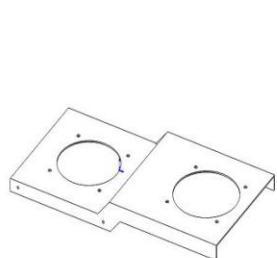

Support Brakect
(optional)

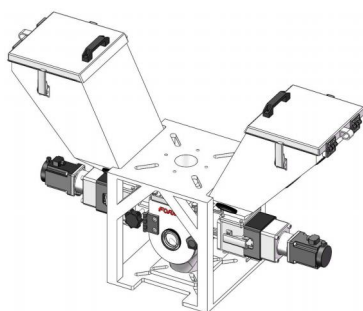

Heavy Base
(optional)

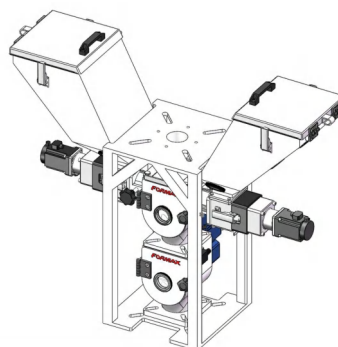

Heavy Base with Mixer
(optional)

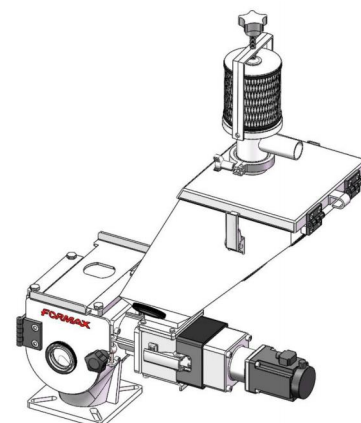

Ventruil Loader
(optional)

Options

- HF heavy base is optional for using with FHD-100~FHD-300.
- MX mixer is for mixing materials evenly.
- MIH material intermediate hopper is for feeding main material.
- LS low level sensor can be adopted to give an alarm when master batch is insufficient.
- SF support bracket is for hopper loaders installed on the hopper of doser.
- LV venturi loader can satisfy consumers' request of small and easy loading device.

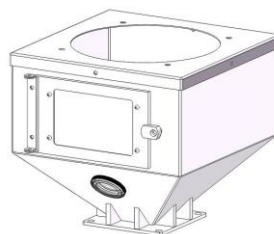

MIH-S18(optional)



MIH-S24(optional)

Application

FVS-SM series volumetric screw dosers are suitable for auto-proportional mixing of virgin materials. The use of the product servo motor can meet the 0.1 ~ 80KG / HR of different output for customers to choose! Double-color dosers are available for collocating with any two of single color dosers required.

Working Principle

Signals from control cabinet are sent to motor, and then motor begins to work. The rotary force is transferred to the dosing screw through shaft connector. Color additives in hopper fall into the groove of conveying screw, then are taken to hopper base by rotating action of the screw.

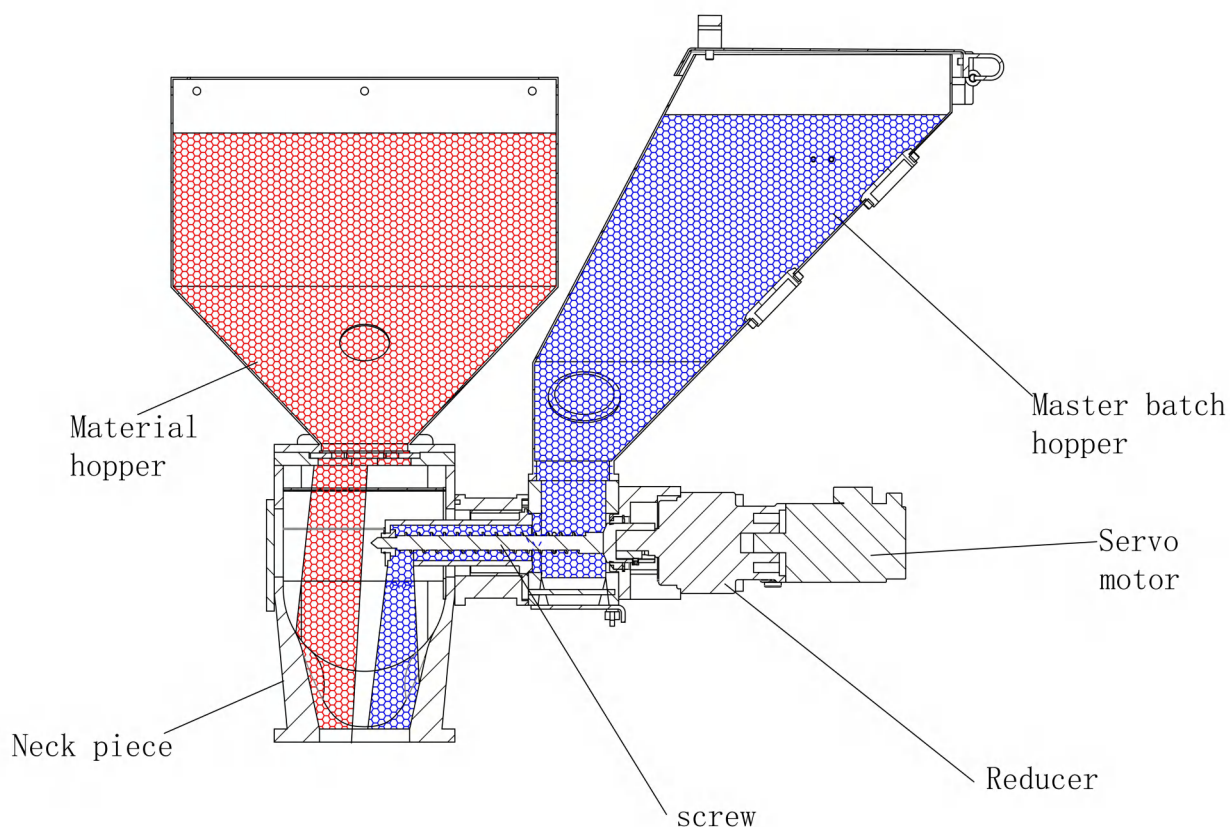

■ Outline Drawings

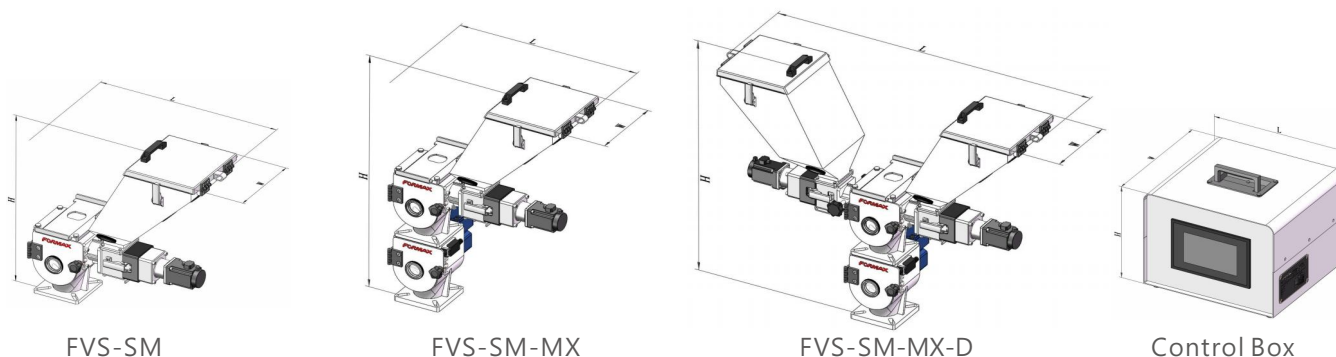

■ Specifications

Model	FVS	FVS-SM	FVS-SM-D
Motor Power	kw	0.4	0.4*2
Screw OD.	mm	16	
Sleeve ID.	mm	27	
Max Output	kg/hr	0.1~80	0.2~160
Master-batch Hopper Capacity	Ltr	10	
Mixing Motor Power	kw	0.09	
Mixing Chamber	Ltr	3L or(6L as Optional)	
Voltage	1Ø, 230VAC, 50/60Hz		
Dimension	L	570	
	W	245/375(with Mixer)	
	H	560/780(with Mixer)	
Weight	kg	30/50(with Mixer)	60/65(with Mixer)

Notes:

- 1) All output capacities of above models are based on data from bulk density 0.65kg/L, dia. 2~3mm master batch in a test criteria of continuous running; The actual output capacity depends on the actual material properties, such as bulk density, flowability, particle size, etc., as well as on the setup recipe.
- 2) When the master-batch hopper is installed with automatic feeding, the total load of the hopper shall not be higher than 25KG (including master-batch).
- 3) Power Supply: 1Ø, 230VAC, 50/60Hz

Specifications are subject to change without prior notice.

FORMAX®

China
Formax Plastics Automation, Inc.

Dongguan
No. 9, Taida Road, Chang'an Town, Dongguan City,
Guangdong Province, China
Tel. +86-769-3899-9898 Fax. +86-769-8533-3467

Kushan
No.138-20, Hengshan Road, Kunshan, Jiangsu, China
Tel. +86-512-5700-8308 Fax. +86-512-5700-8306

Taiwan
Formax Equipment Inc.

No.12, Ln.12, Anzhong st., Luzhu Dist.,
Taoyuan City, Taiwan
Tel. +886-3-2121-725 Fax. +886-3-2127-960

www.formaxpa.com
www.formax88.com



2024-10 All rights reserved.